

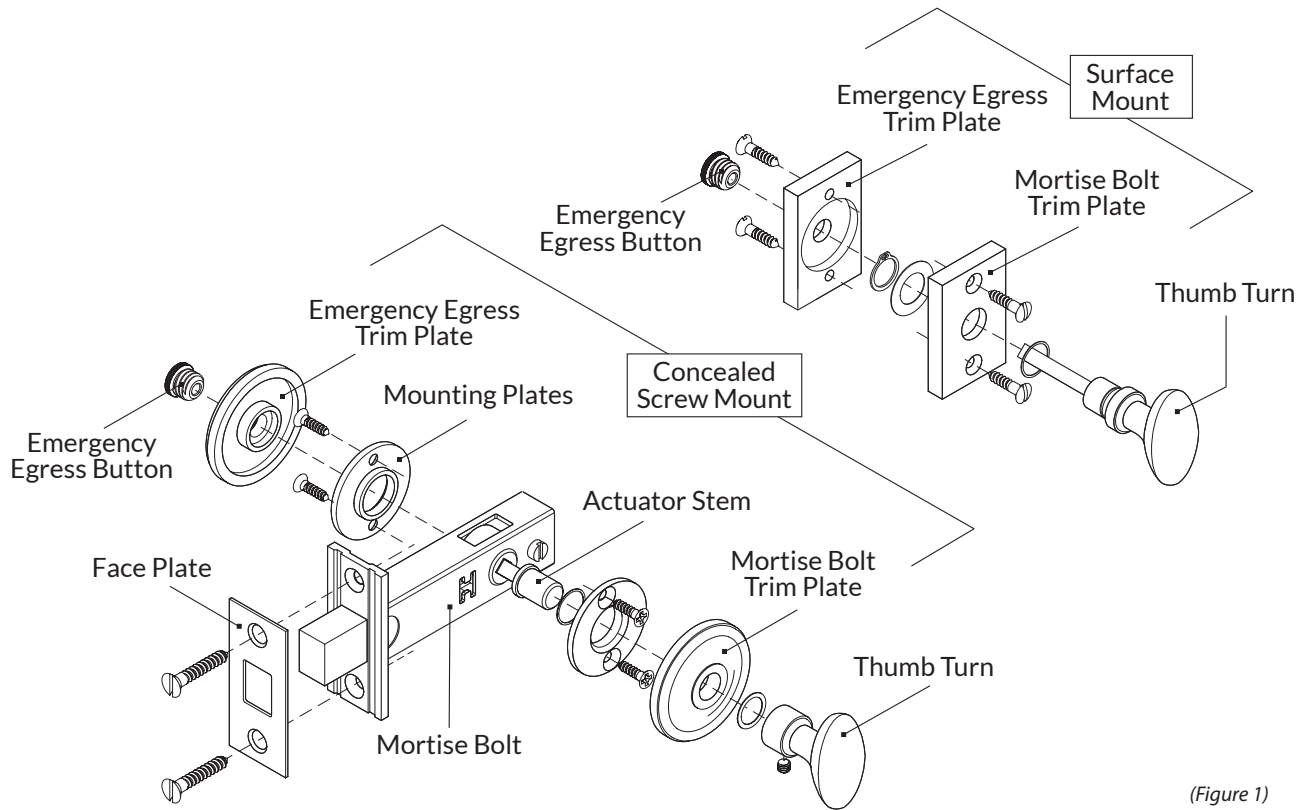

## TS-MB - TUBULAR SECTIONAL MORTISE BOLT PRIVACY SETS



(Figure 1)

### PREPARE DOOR & INSERT LATCH

1. Determine the desired location of the mortise bolt on your door. Prepare the door according to the template provided.
2. Use the face plate to mark the screw locations on the edge of the door, then drill 1/16" pilot holes (x2).
3. Install the mortise bolt and face plate with the screws provided. Do not over tighten the screws or binding may occur. (Figure 2)

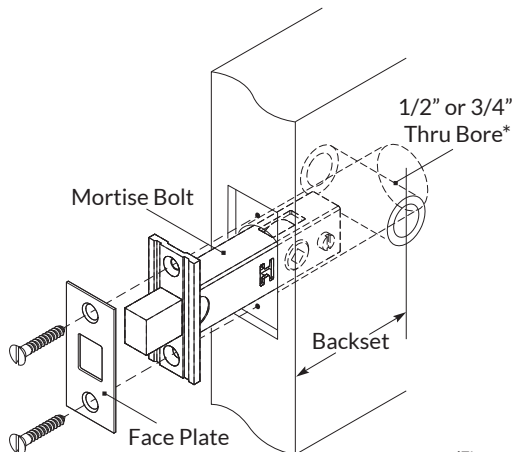

(Figure 2)

### DOOR JAMB

4. Measure the jamb to determine the location the mortise bolt strikes when the door is fully closed. Using the strike plate template provided, prepare the door jamb to accept the dust box and strike plate.
  5. Install the face plate and dust box cavity as shown. (Figure 3)
- After installation, if the latch does not fully engage with the strike, loosen the screws and adjust.

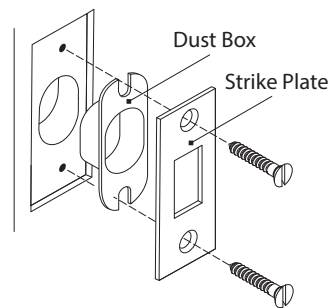

(Figure 3)



## TS-MB - TUBULAR SECTIONAL MORTISE BOLT PRIVACY SETS

### INSTALL THE TRIM

\*Determine the type of trim you are using before drilling the thru bore. Surface mount or tap-in trim uses a 1/2" thru bore.

### CONCEALED SCREW TRIM

The interior trim plate assembly will arrive pre-assembled. This includes the actuator stem, the mortise bolt trim plate, the thumb turn.

6. Position the mounting plates over the 3/4" thru bore hole. Mark the screw locations and drill 3/32" pilot holes. Secure the mounting plates to the door with the screws provided.
7. Determine the thumb turn stem length required to go half way through the mortise bolt hub. Cut the stem to length.
8. Insert the stem into the mortise bolt hub, then attach the interior trim plate by hand threading it onto the mounting plate. Repeat the process with the exterior emergency egress plate. (Figure 4)

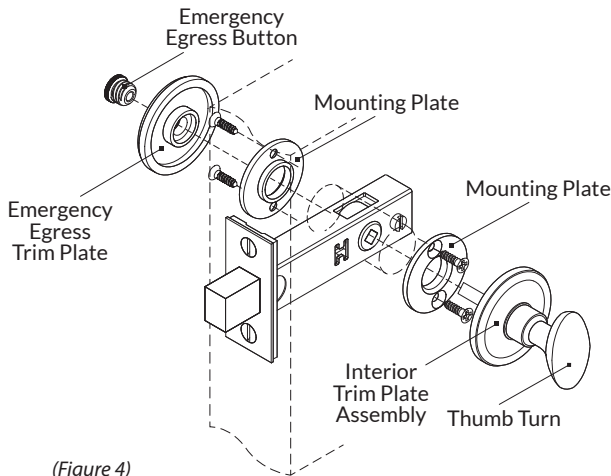

(Figure 4)

Check the function of the thumb turn in operating the bolt. If binding occurs you may need to loosen the face plate screws and adjust the mortise bolt position until smooth operation is achieved.

### SURFACE MOUNT TRIM

The interior mortise bolt trim plate will arrive pre-assembled with the thumb turn attached.

6. Position the interior mortise bolt trim plate over the 1/2" thru bore hole. Mark screw locations and drill 1/16" pilot holes.
7. Determine the thumb turn stem length required to go half way through the mortise bolt hub. Cut the stem to length.
8. Insert the stem into the mortise bolt hub, then attach the interior trim plate by screwing it onto the door surface. Repeat the process with the exterior emergency egress plate\*. When installed, screw the emergency egress button into the trim plate. (Figure 5)

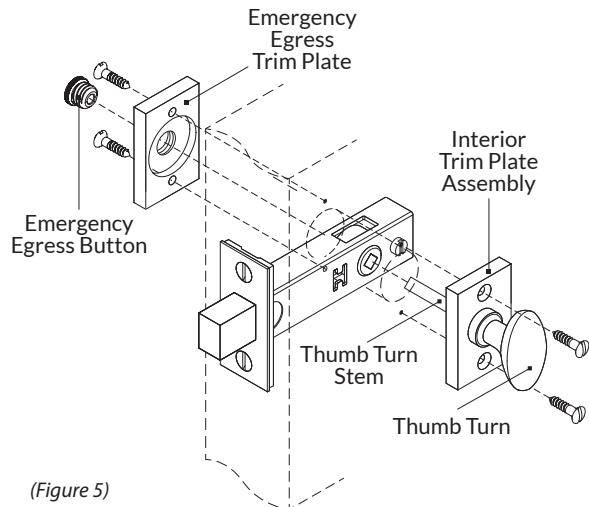

(Figure 5)

### \*TAP IN EMERGENCY EGRESS TRIM

If your emergency egress trim is the optional tap in variety, use a rubber mallet to gently tap the emergency egress collar into the 1/2" thru bore on the exterior side of the door. When installed, screw the emergency egress button into the trim plate. (Figure 6)

Note: Tap in emergency egress trim not available for 3/4" thru bore.

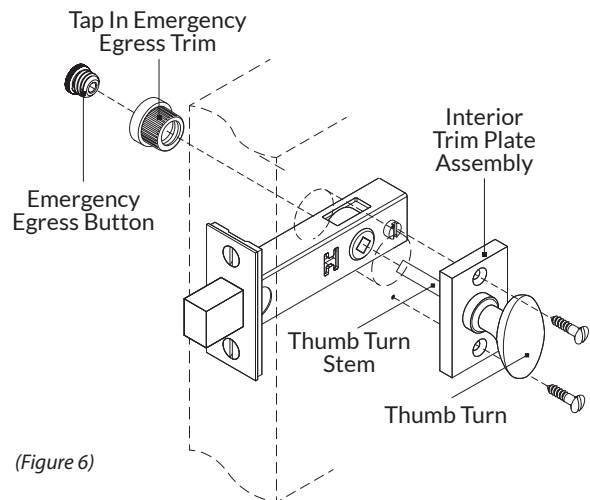

(Figure 6)



WATER STREET

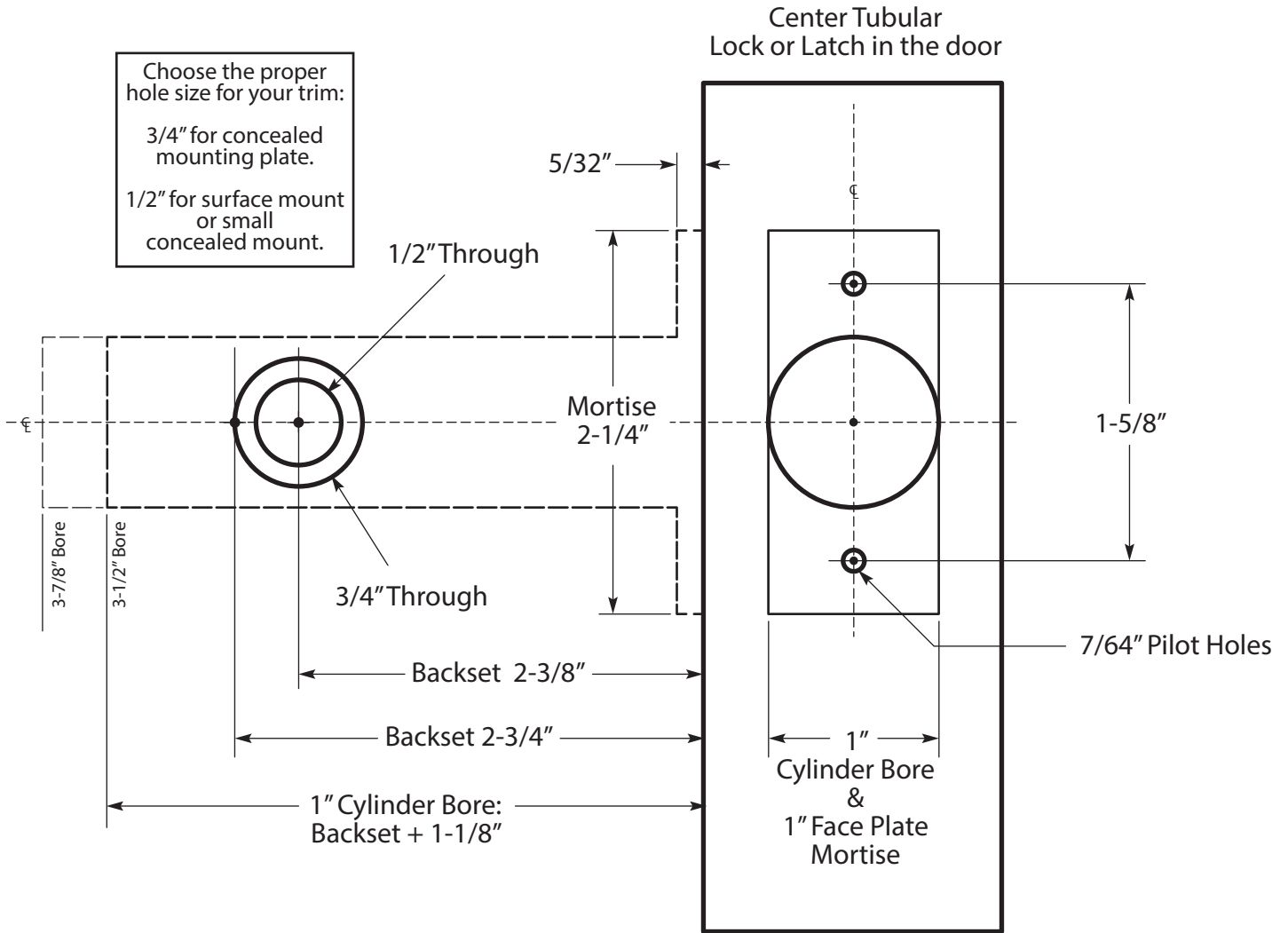

Proprietary And Confidential

© WSB Hardware, Inc. 2021

Any reproduction in part or as a whole without the written permission of Water Street Brass is prohibited.

WS40312  
Tubular Privacy Bolt Template



WATER STREET

## Mortise Bolt Strike

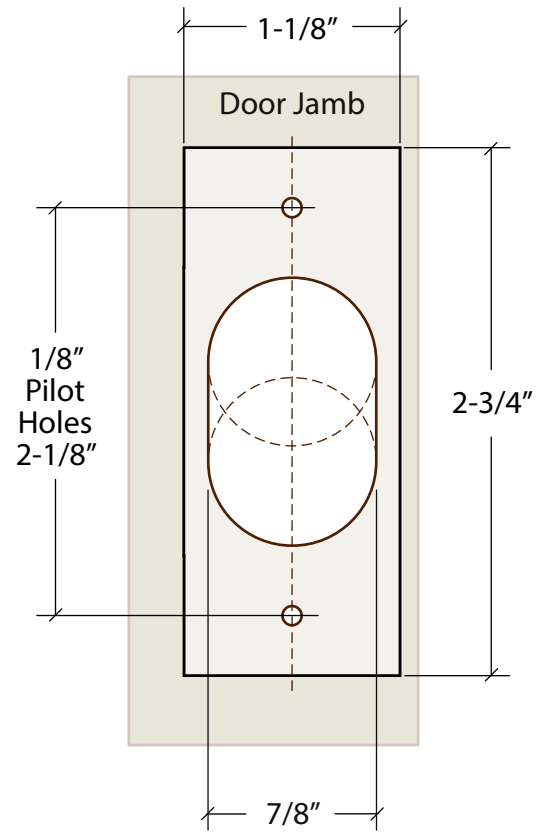
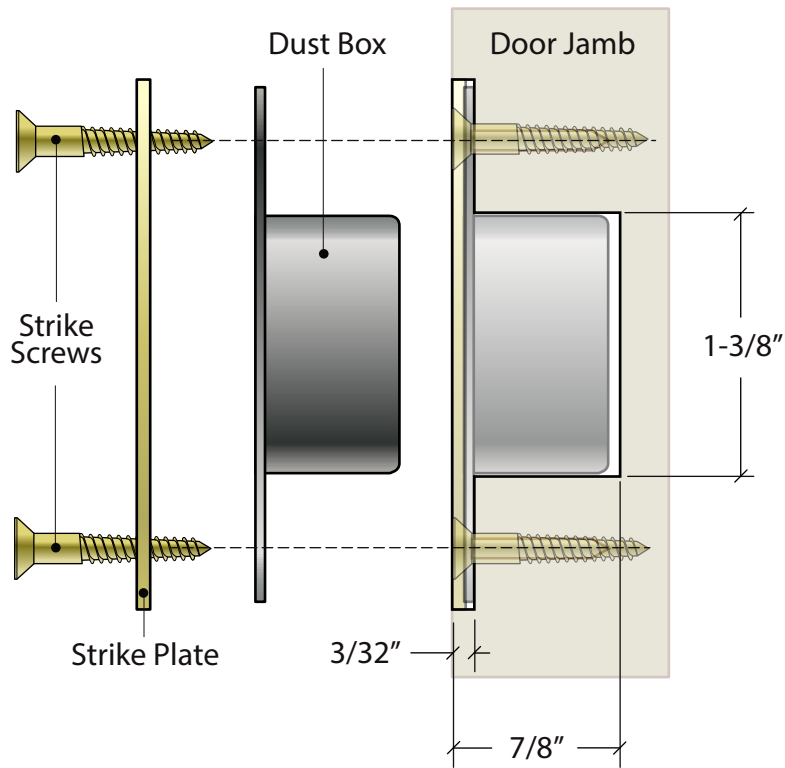

## Auxiliary Deadbolt Strike

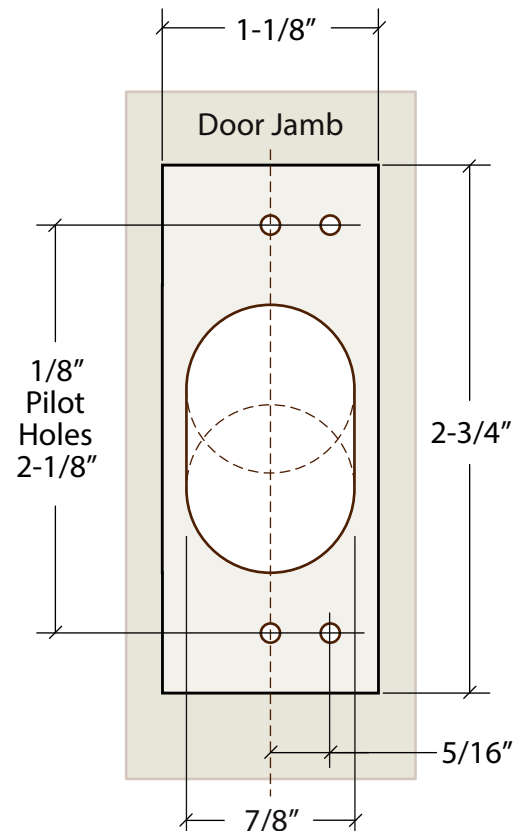
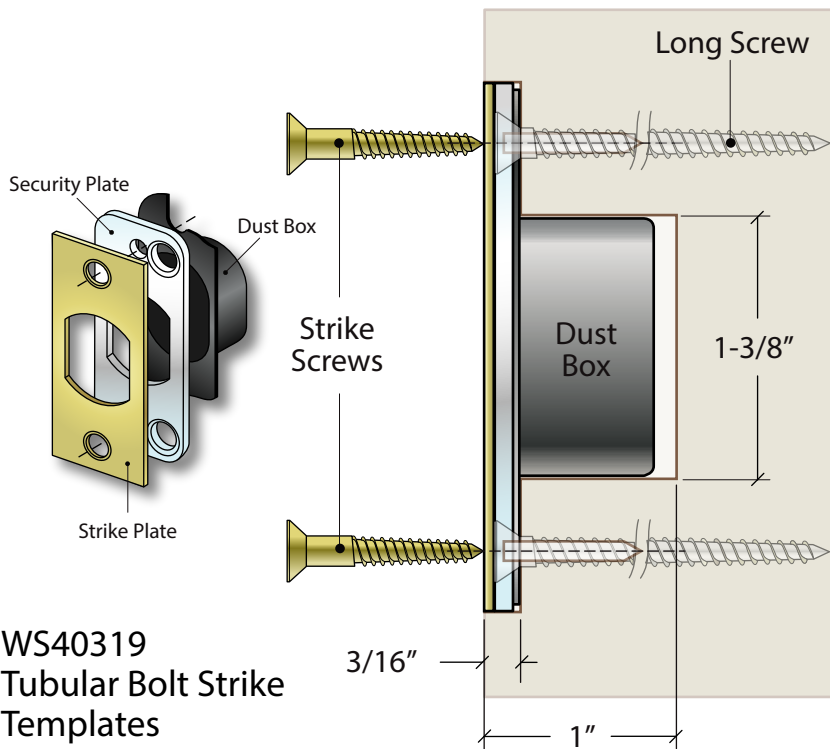

WS40319  
Tubular Bolt Strike  
Templates