

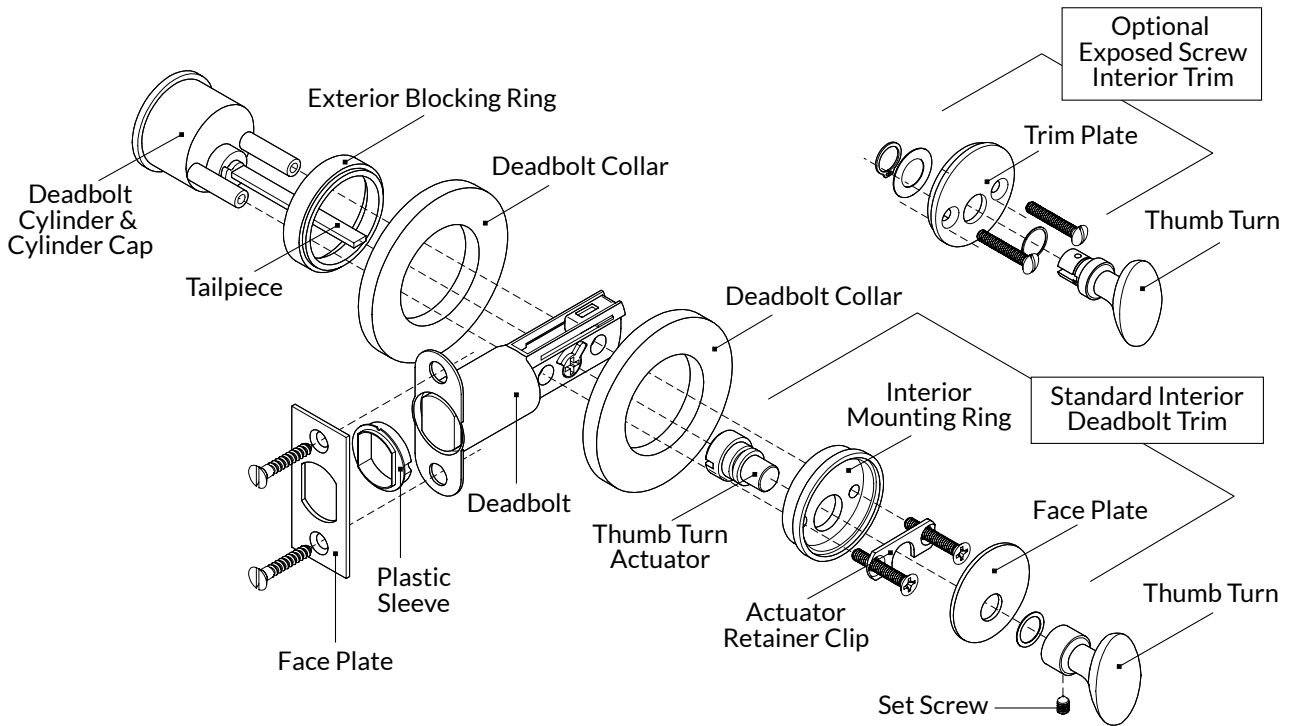

**WATER STREET.**

JAMESTOWN NEW YORK

## TDB-EN - TUBULAR DEADBOLT ENTRY SET



(Figure 1)

### PREPARE DOOR & INSERT DEADBOLT

1. Determine the desired location of the deadbolt on your door. Prepare the door according to the template provided.
2. Use the face plate to mark the screw locations on the edge of the door, then drill the two pilot holes for the screws.
3. Install the deadbolt, plastic sleeve and face plate with the screws provided. Do not over tighten the screws or binding may occur. (Figure 2)

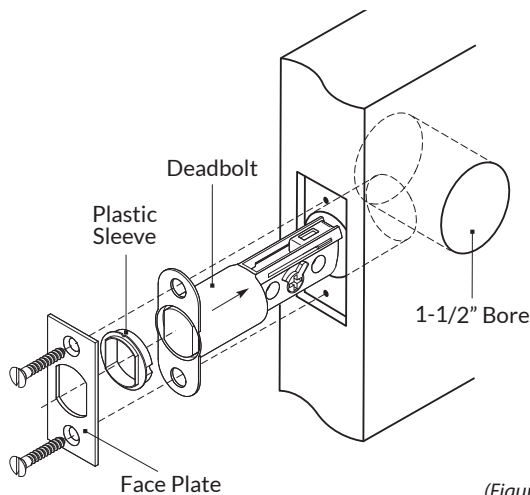

(Figure 2)

### CYLINDER PREPARATION

4. Fit the deadbolt cylinder, blocking ring, and exterior deadbolt collar on the door by sliding the tailpiece through the deadbolt hub. The mounting hubs on the cylinder will pass through the deadbolt body. With this assembly against the exterior door surface, mark the length of the tailpiece at the point it reaches the interior face of the door.
5. Find the tailpiece score line to the inside of the door surface mark and cut the tailpiece at that line. You may need to further trim this tailpiece so that it fits into the thumb turn actuator without binding. (Figure 3)

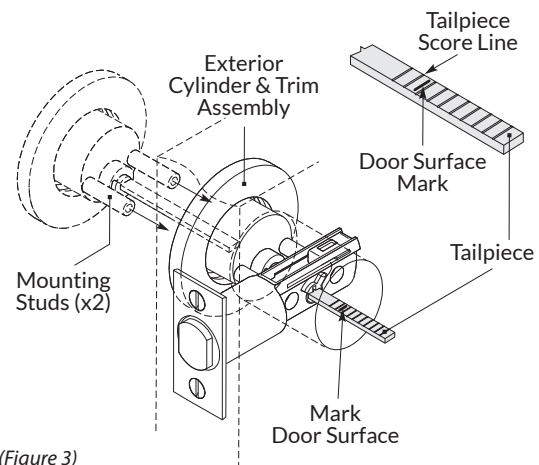

(Figure 3)



## TDB-EN - TUBULAR DEADBOLT ENTRY SET

### STANDARD INTERIOR TRIM

Note: The interior mounting plate assembly is typically shipped assembled. You may need to disassemble the thumb turn and face plate prior to installation. Simply loosen the thumb turn set screw and slide off the actuator. Do not disassemble the retaining clip from the actuator.

6. Position the interior mounting ring assembly into the deadbolt collar, then position them on the door. Make sure the thumb turn actuator is oriented with the tailpiece slot horizontal and the set screw dimple facing downward. The tailpiece must fit in the slot.
7. Secure this assembly to the deadbolt cylinder mounting studs using the two machine screws provided. (Figure 4)

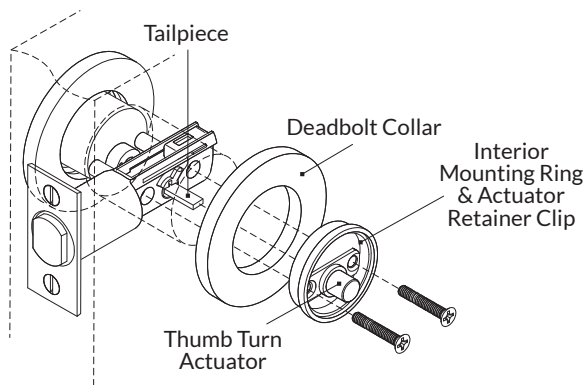

(Figure 4)

8. Position the face plate into the mounting ring assembly. Slide the nylon washer and the thumb turn over the thumb turn actuator stem, then secure with the set screw. (Figure 5)

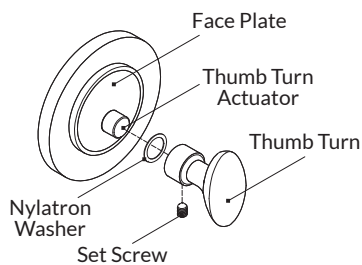

(Figure 5)

Test the function of the deadbolt with the thumb turn and with the key. If binding of the bolt occurs try loosening the face plate screws until smooth operation is achieved.

### EXPOSED SCREW INTERIOR TRIM

6. Position the trim plate assembly into the deadbolt collar, then position them on the door. Orient the slot in the thumbpiece horizontally so that the tailpiece fits in the slot.
7. Secure this assembly to the deadbolt cylinder mounting studs using the two machine screws provided. (Figure 6)

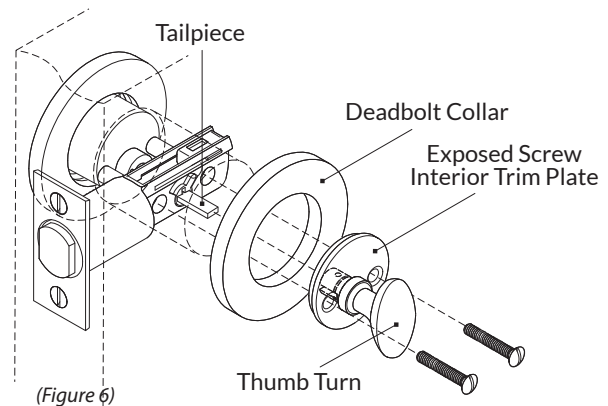

Test the function of the deadbolt with the thumb turn and with the key. If binding of the bolt occurs try loosening the face plate screws until smooth operation is achieved.

### DOOR JAMB

8. Measure the jamb to determine the location the deadbolt strikes when the door is fully closed. Using the strike plate template provided, prepare the door jamb to accept the dust box, security plate, and the strike plate.
9. Begin the installation by inserting the dust box and the security plate in the door cavity. Secure by firmly installing the two security screws into the door jamb.
10. Finish the installation by attaching the strike plate as shown. (Figure 7)

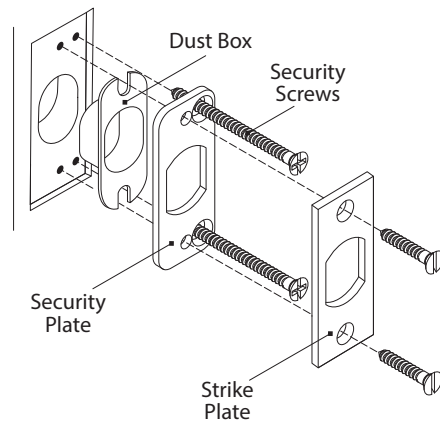

(Figure 7)

After installation, if the latch does not fully engage with the strike, loosen the screws and adjust.



WATER STREET

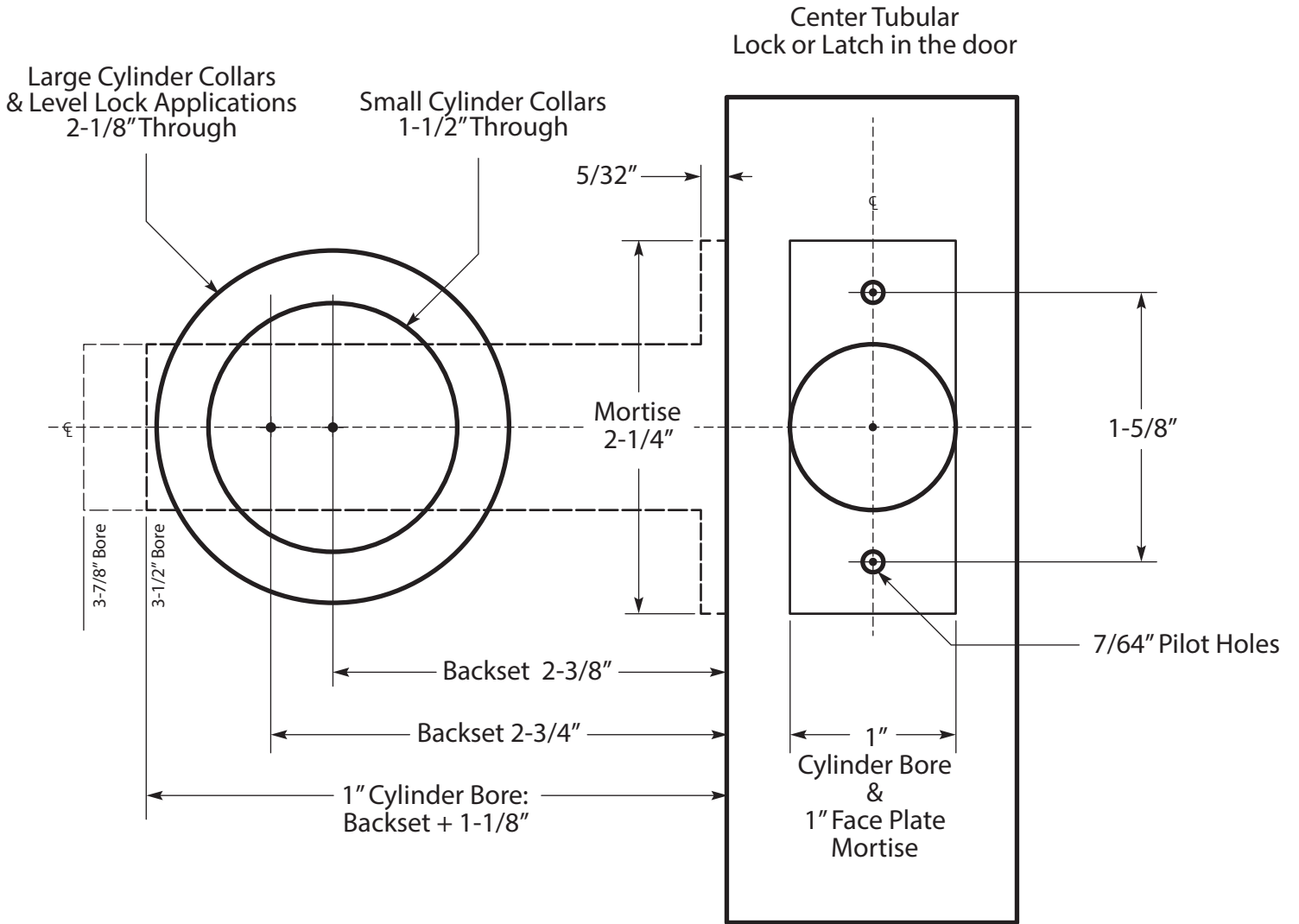

Proprietary And Confidential

© WSB Hardware, Inc. 2024

Any reproduction in part or as a whole without the written permission of Water Street Brass is prohibited.

WS40311  
Tubular Auxiliary Deadbolt Template



WATER STREET

## Mortise Bolt Strike

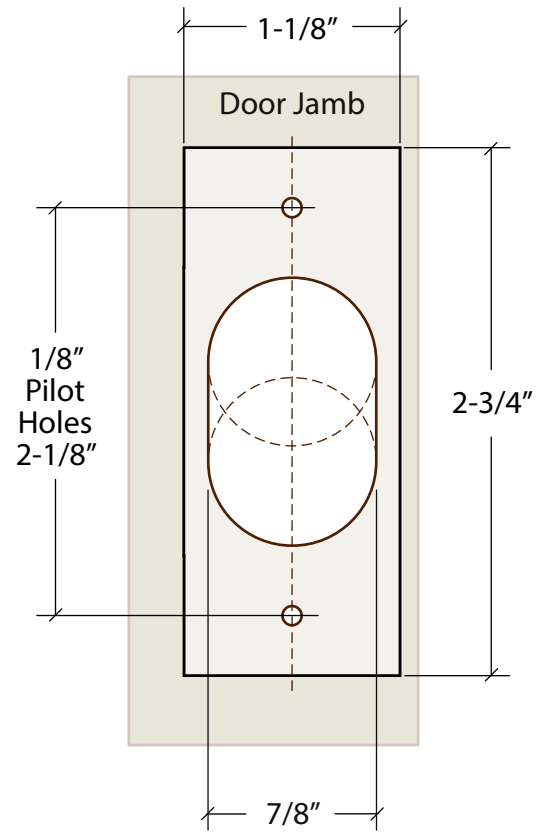
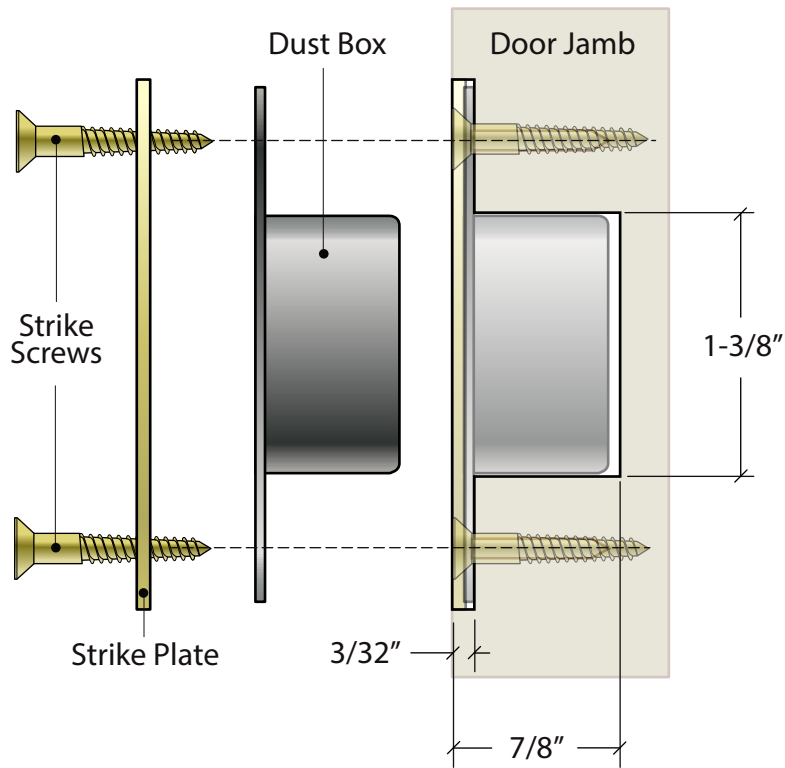

## Auxiliary Deadbolt Strike

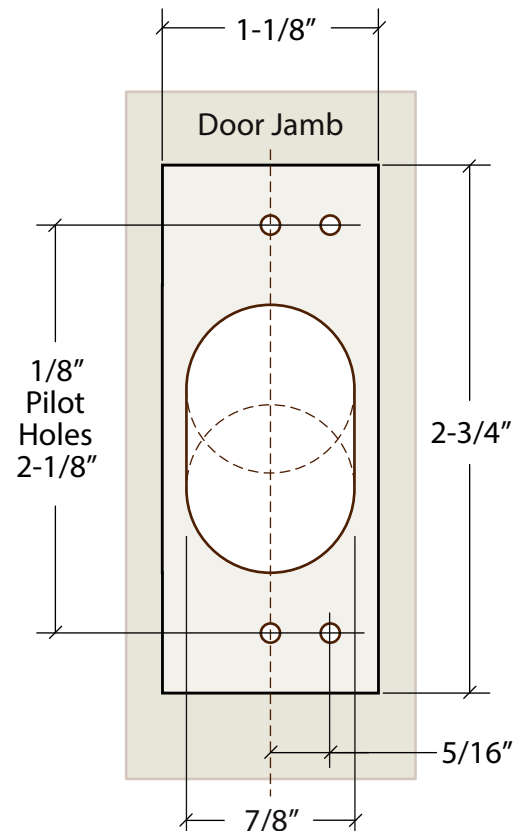
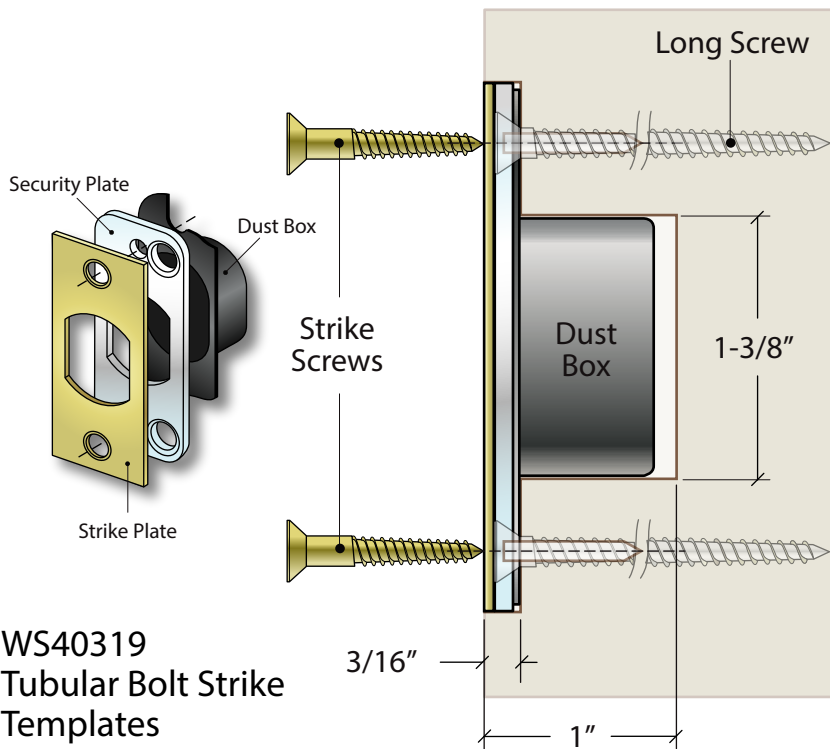

WS40319  
Tubular Bolt Strike  
Templates