

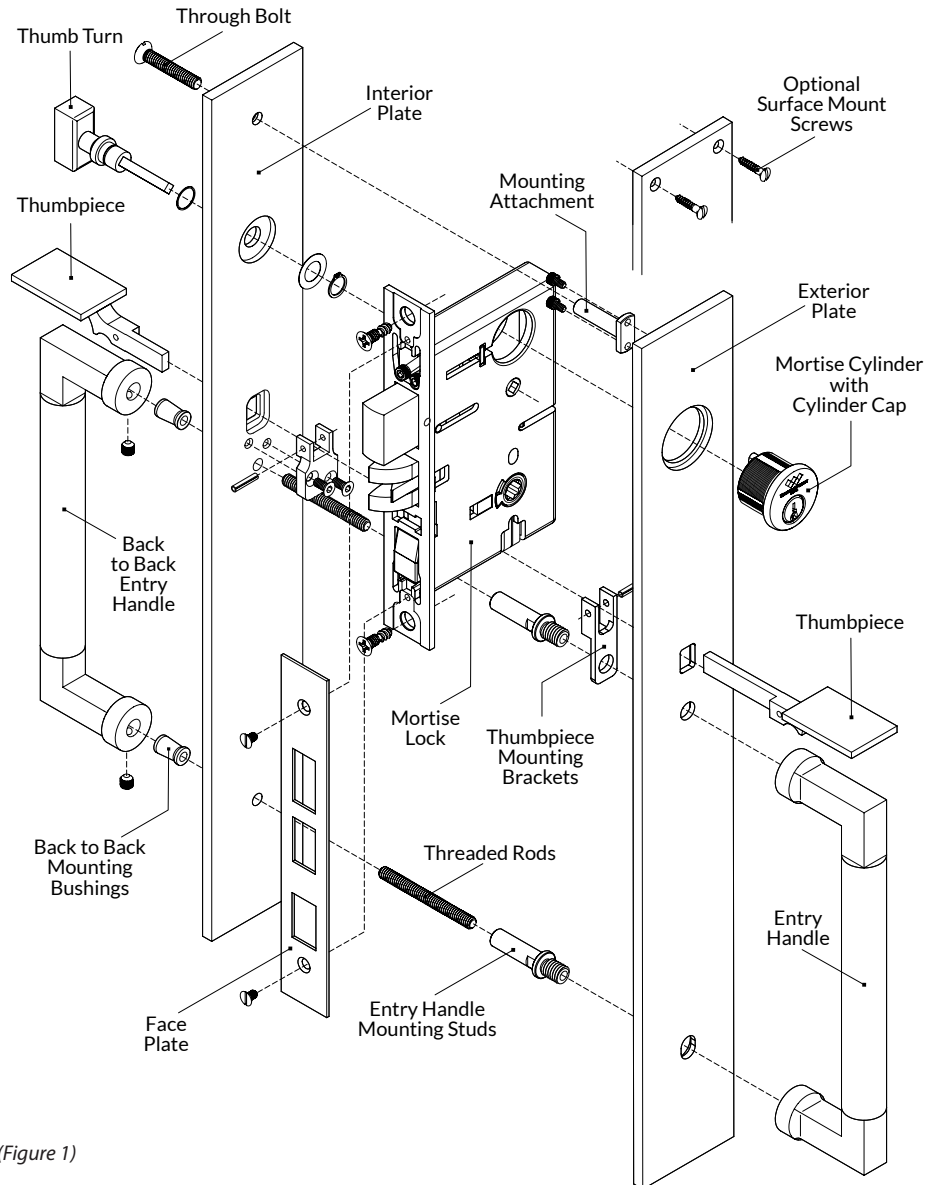

WATER STREET.
JAMESTOWN NEW YORK

MTT-EN MORTISE THUMBPIECE X THUMBPIECE ENTRY HANDLE SETS



(Figure 1)

ENTRY SET

An MTT entry handle set features a mortise lock and latch operated by thumbpieces on both sides of the door.

- The exterior plate has a thumbpiece and entry handle, with entry handle mounting studs. It may include a mortise cylinder.
- The interior plate has a thumbpiece and entry handle, with an exposed through bolt. It may include a thumb turn or lock cylinder.

Mortise locks can be ordered with a wide range of features and functions, including storeroom, privacy, or patio. They may be electronically operated or feature magnetic latching mechanisms. Regardless of the function chosen, the basic installation covered in these instructions remains the same.

PREPARE DOOR

1. Prepare the door according to the template provided. If optional surface mount screws are to be used, use the escutcheon plates to mark the hole locations to drill pilot holes.



WATER STREET.

JAMESTOWN NEW YORK

MTT-EN MORTISE THUMBPIECE X THUMBPIECE ENTRY HANDLE SETS

INSTALL THE MORTISE LOCK

2. Insert the mortise lock body into the cavity and mark the lock screw locations. Drill pilot holes for the screws, then install the lock using the screws provided. Metal doors require two #12-24 tapped holes for the combination screws. (Figure 2)

Do not install the lock face plate at this time.

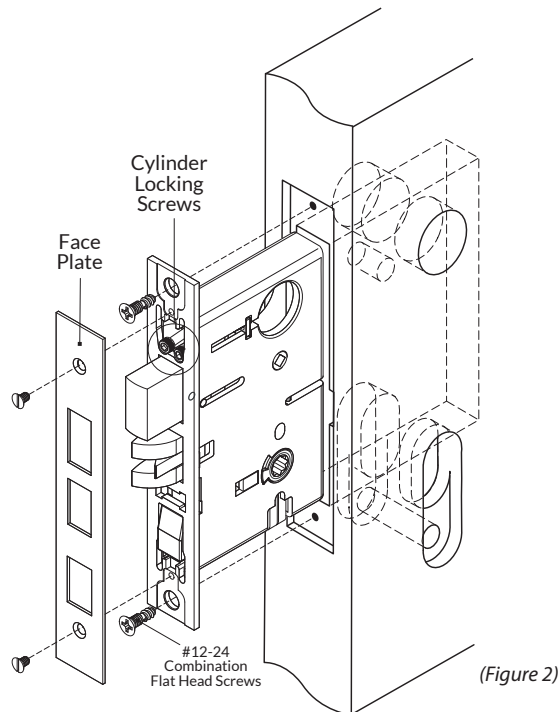

(Figure 2)

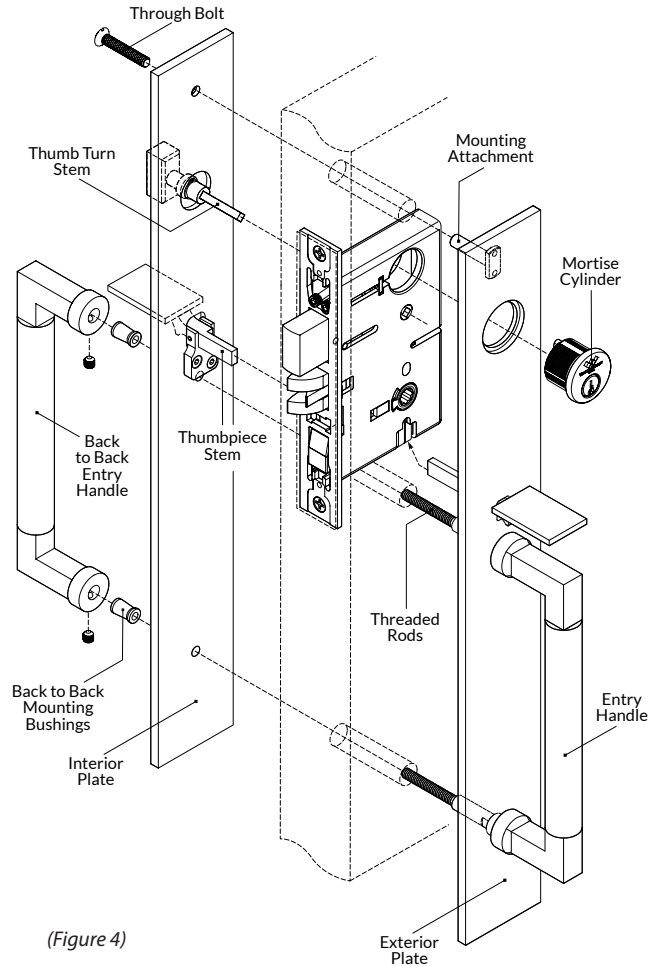

(Figure 4)

MEASURE AND CUT STEMS

3. Measure the position of the lock body in the door to determine the stem cut lengths.

Prior to installation, mark each thumbpiece stem and cut so that it extends no further than the far side of the lock body from its side of the door.

The lock may not be centered in the door, so your stems may be cut to different lengths.

4. Measure and cut the thumb turn stem so it extends at least halfway through the lock body when installed. (Figure 3)

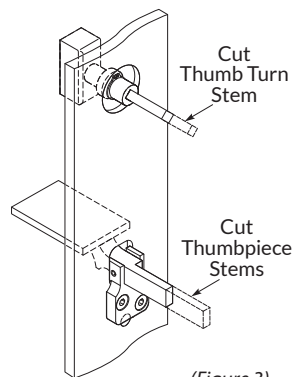

(Figure 3)

INSTALL THE ESCUTCHEON PLATES

5. Screw the two threaded rods into the entry handle mounting studs. Fit the exterior plate and entry handle onto the door surface, passing the mounting studs through the bore holes. Make sure the exterior thumbpiece stem rests under the lock actuator. (Figure 4)

6. To help locate this plate on the door, thread the mortise cylinder into the lock body until it is fully seated in the plate and properly oriented. A cylinder blocking ring may be required.

7. Next, position the interior plate on the door. Slide the thumb turn stem into the lock. The thumbpiece stem will rest under the actuator and both threaded rods will pass through the handle mounting holes.

8. Install the back to back mounting bushings onto the threaded rods. Make sure both plates are square and parallel to the door edge, and adjust as needed. Tighten mounting bushings.

9. From the interior side, install the upper through bolt into the mounting attachment and tighten firmly.

If surface mount screws are to be used, now is when you should mark the screw hole locations and drill pilot holes. Install the screws.



WATER STREET.
JAMESTOWN NEW YORK

MTT-EN MORTISE THUMBPIECE X THUMBPIECE ENTRY HANDLE SETS

10. Test the function of the key in the cylinder. When satisfied with the operation of the lock, tighten the cylinder locking screw. *(Figure 2)*

Repeat the process on the interior side of the door for a double cylinder, key by key function.

FINISH INSTALLATION

11. Fit the interior back to back entry handle onto the mounting bushings. If the threaded rod protrudes too far to allow the handle to seat, you may need to cut the rods to a suitable length.

12. With the back to back handle firmly seated to the interior plate, tighten the two set screws firmly using an Allen wrench. *(Figure 4)*

13. Install the lock face plate at this time. *(Figure 2)*

MORTISE LOCK STRIKE PLATE

Depending on the lock model, function, and handing, the strike plate and dust box may appear differently than shown below.

14. Measure the jamb to determine the location the latch bolt strikes when the door is fully closed. Using the strike plate template provided, prepare the door jamb to accept the dust box and strike plate.

Note: Determine the handing required. Mortise the jamb accordingly.

15. Install the dust box and face plate with the screws provided. Make sure the face plate sits flush with the jamb surface; deepen the cavities as needed. After installation, if the latch does not fully engage with the strike, loosen the screws and adjust. *(Figure 5)*

